



# BATTERY BULL ELECTRIC

## Four, Five & Six Level Models

The BBE Series man-aboard Battery Bull Electric offers new levels of performance, reliability and safety to support your high-volume and high-density battery change requirements. This product is available as a single level system, up to a 6-level system.

The BBE is the industry's first fully electric system with no hydraulics, which ensures maximum up-time and minimum maintenance.

Powerful, compact and energy efficient PLC controlled Variable Frequency Drives (VFD) are coupled with electric gear boxes to provide simultaneous power to both the lift and drive functions. The BBE is one of the few options in high-volume fully electric transfer carts.

### GET IN TOUCH

[info@carneybatteryhandling.com](mailto:info@carneybatteryhandling.com)  
[www.carneybatteryhandling.com](http://www.carneybatteryhandling.com)

Tel: 1.905.564.0303  
Toll free: 1.866.THE.BULL

2A - 14 Reagan Road  
Brampton Ontario L7A 1B9

# BBE 4-6 Levels

## Features and Benefits

### - Laser Height Alignment Indicator

*Visually displays the exact height of roller bed carriage for precision alignment when transferring batteries into racks or lift vehicles*

### - Operator Safety Gate Lock Out

*Safety Proximity Switch prevents vehicle operation unless the compartment gate is closed, and the E-Stop/Start Button is engaged*

### - Carriage Outboard Rollers

*Aids to bridge the gap between truck and battery changer*

### - Latched Thumb Switch on Joystick

*This new feature allows the operator to press and hold the magnet button to attach to the battery and when released the magnet is off*

### - Solid Steel Core Urethane Coated Roller Bed

*This ensures more traction to the bottom of the battery while transferring as well as long service life*

### - Dual bridge position monitoring sensors from "Sick"

*Programmed and set up to extend the life of the bridge motors and clutches*

### - Emergency Stop Control

*Safety relay monitored to safely decelerate all motions and come to complete stop*

### - Battery Presence Photo Eye Safety System

*Electronic Photo Eyes sense the batteries in the carriage and cut power to the roller beds. Operator must press the Override Release Button to discharge batteries from the carriage*

### - New 95 Durometer Poly Load Wheels

*Increases load wheel life and prevents wheel memory*

### - Powered Outboard Carriage Rollers

*Requires less magnet arm travel to allow faster removal and replacement of batteries into racks and vehicles*

### - Precision Variable Frequency Drives (VFD) for both Raise/Lower and Travel Functions

*Allows smooth ramp speed starts and stops to both travel and lift functions. Allows for speed adjustments depending on the size of the system*

### - Ergonomic dash panel and control station

*Intuitive controls that allow battery changes at all operator skill levels*

## Available Options

OPTIONS	DESCRIPTION
Battery Carriage/ Bed LED Spot Lamps	Allows additional light for battery changes
"Sick" Laser Pedestrian Safety Protection	Laser distance travel stops
Allen Bradley Light Tower	Activation status / Travel Alarm
Auto Position System with PLC	Touch Screen Control
Auto Level System	To align BBE with racks
Cameras & Monitor	Allow viewing of the roller bed and / or front of the BBE

# BBE 4-6 Levels

## DIMENSIONS

### Four, Five and Six Level Models

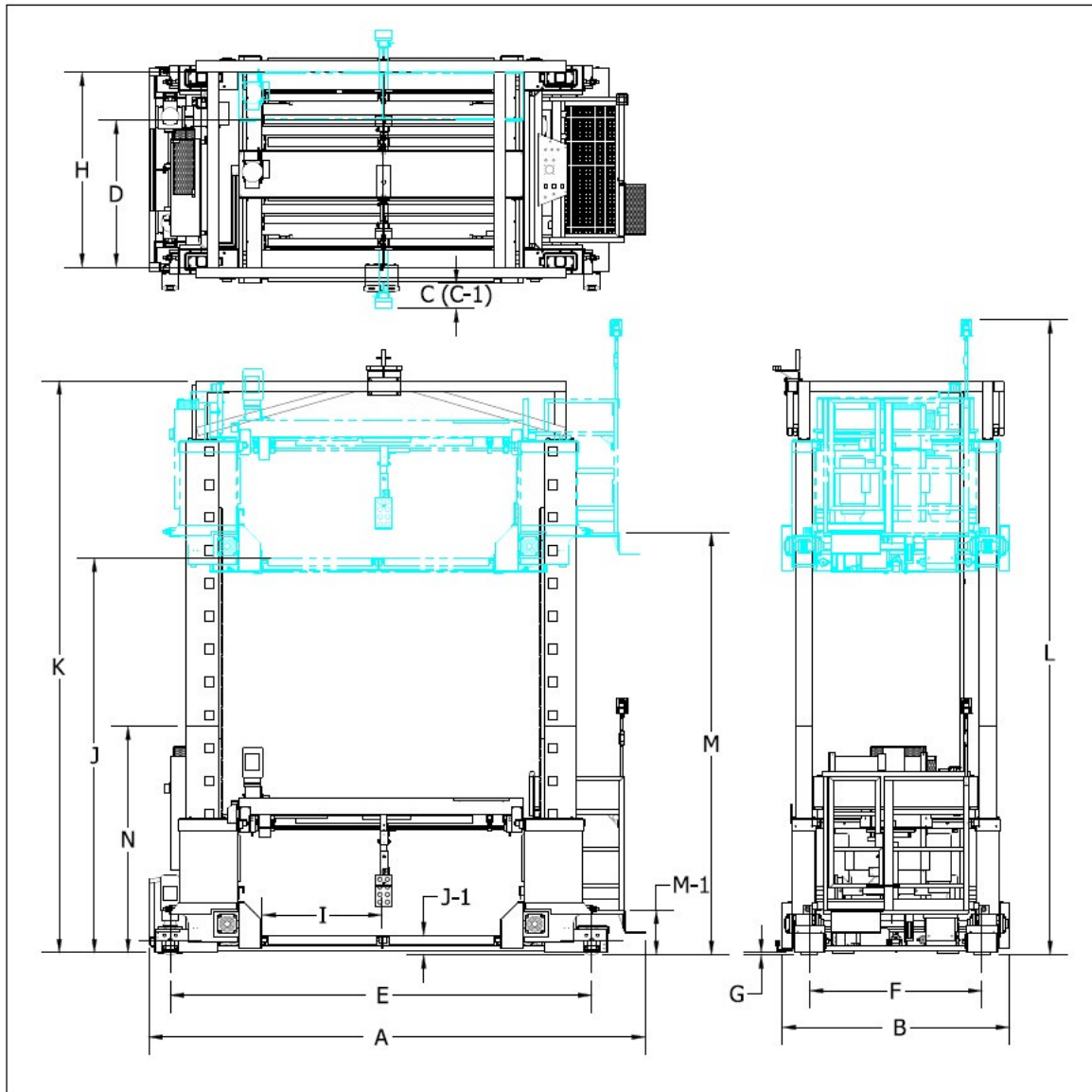

# BBE 4-6 Levels

3D RENDERING

## Four, Five and Six Level Models

---

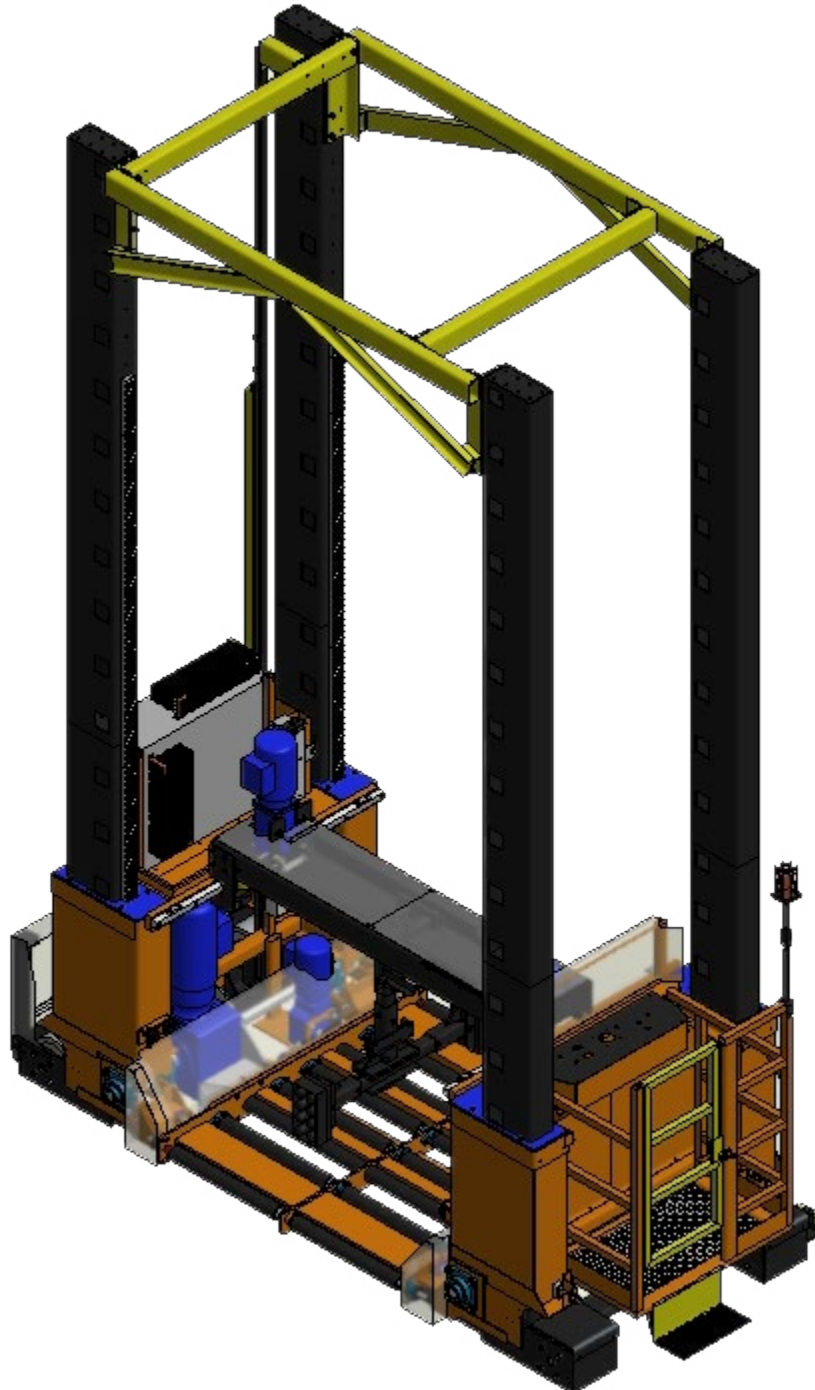



# BBE 4-6 Levels

## GENERAL SPECIFICATIONS

	MODEL NO.	BBE-2-30		BBE-2-36		BBE-2-42		BBE-2-48	
1	Drive System H.P. / KW	2 x 2 HP	2 x 1.5 KW	2 x 2 HP	2 x 1.5 KW	2 x 2 HP	2 x 1.5 KW	2 x 2 HP	2 x 1.5 KW
2	Raise/Lower H.P. / KW	2 x 7.5 HP	2 x 5.6 KW	2 x 7.5 HP	2 x 5.6 KW	2 x 7.5 HP	2 x 5.6 KW	2 x 7.5 HP	2 x 5.6 KW
3	Raise/Lower Speed	0-30 FPM	0-9.14 MPM	0-30 FPM	0-9.14 MPM	0-30 FPM	0-9.14 MPM	0-30 FPM	0-9.14 MPM
4	Travel Speed	0-175 FPM	0-53.5 MPM	0-175 FPM	0-53.5 MPM	0-175 FPM	0-53.5 MPM	0-175 FPM	0-53.5 MPM
5	Machine Duty Cycle (Per Year)	5,500 Hrs.		5,500 Hrs.		5,500 Hrs.		5,500 Hrs.	
6-A	Input Voltage / Frequency / Max Current Drawn	415 V / 50 Hz / 30 A		415 V / 50 Hz / 30 A		415 V / 50 Hz / 30 A		415 V / 50 Hz / 30 A	
6-B	Input Voltage / Frequency / Max Current Drawn	460 V / 60 Hz / 28 A		460 V / 60 Hz / 28 A		460 V / 60 Hz / 28 A		460 V / 60 Hz / 28 A	
6-C	Input Voltage / Frequency / Max Current Drawn	575 V / 60 Hz / 26 A		575 V / 60 Hz / 26 A		575 V / 60 Hz / 26 A		575 V / 60 Hz / 26 A	
7	Control Voltage	110 VAC	24 VDC	110 VAC	24 VDC	110 VAC	24 VDC	110 VAC	24 VDC
8	Draw Bar Pull Magnet	1800 lbs	817 kg	1800 lbs	817 kg	1800 lbs	817 kg	1800 lbs	817 kg
9	Magnet Break Off Point (1/4", 3/16", 1/8")	1800, 1200, 700 lbs.		1800, 1200, 700 lbs.		1800, 1200, 700 lbs.		1800, 1200, 700 lbs.	
10	Power Unit Type	Electric		Electric		Electric		Electric	
11	Wheel Type / Size (Dia x Width)	10" x 6"	254x153 mm	10" x 6"	254x153 mm	10" x 6"	254x153 mm	10" x 6"	254x153 mm
12	Capacity (Fully Loaded)	10000 lbs	4536 kgs	10000 lbs	4536 kgs	10000 lbs	4536 kgs	10000 lbs	4536 kgs
13	Service weight (Empty)	9775 lbs	4434 kgs	10275 lbs	4661 kgs	10775 lbs	4888 kgs	11275 lbs	5515 kgs

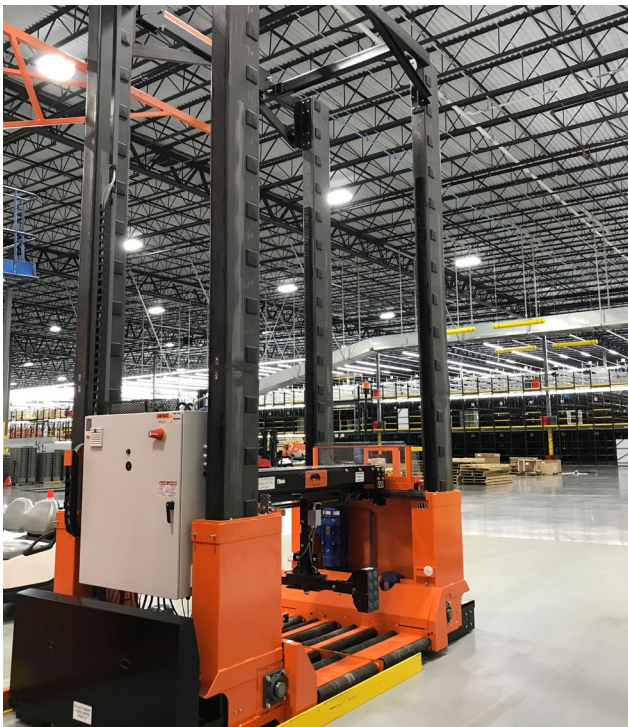

# BBE 4-6 Levels

## DIMENSIONAL DATA

	MODEL NO.	BBE-2-30		BBE-2-36		BBE-2-42		BBE-2-48	
A	Overall Length	154.88"	3934 mm	166.88"	4239 mm	178.88"	4543 mm	190.88"	4848 mm
B	Overall Width (Standard)	71.75"	1822 mm	71.75"	1822 mm	71.75"	1822 mm	71.75"	1822 mm
C	Max. Magnet Arm Reach (Standard Arm)	8.75"	222 mm	8.75"	222 mm	8.75"	222 mm	8.75"	222 mm
C-1	Max. Magnet Arm Reach (Extension Arm)	Customized to suit		Customized to suit		Customized to suit		Customized to suit	
D	Bridge Travel	53.5"	1359 mm	53.5"	1359 mm	53.5"	1359 mm	53.5"	1359 mm
E	Wheel Base	127.5"	3239 mm	139.5"	3543 mm	151.5"	3848 mm	163.5"	4153 mm
F	Centerline of Drive Wheels	51.60"	1311 mm	51.60"	1311 mm	51.60"	1311 mm	51.60"	1311 mm
G	Ground Clearance	0.75"	19 mm	0.75"	19 mm	0.75"	19 mm	0.75"	19 mm
	Grade Percent	1%	1%	1%	1%	1%	1%	1%	1%
H	Battery Compartment Size Length	58.5"	1486 mm	58.5"	1486 mm	58.5"	1486 mm	58.5"	1486 mm
I	Battery Compartment Overall Width	30"	762 mm	36"	914 mm	42"	1067 mm	48"	1219 mm
	Max. Battery Length	60"	1524 mm	60"	1524 mm	60"	1524 mm	60"	1524 mm
	Max. Battery Width	24"	610 mm	30"	762 mm	36"	914 mm	42"	1067 mm
	Max. Battery Height	37"	940 mm	37"	940 mm	37"	940 mm	37"	940 mm
	Min. Battery Length	18"	457 mm	18"	457 mm	18"	457 mm	18"	457 mm
	Min. Battery Width	6"	152 mm	6"	152 mm	6"	152 mm	6"	152 mm
	Min. Battery Height	20"	508 mm	20"	508 mm	20"	508 mm	20"	508 mm
	Min. Over Travel (Front)	98"	2489 mm	108"	2743 mm	116"	2946 mm	125"	3175 mm
	Min. Over Travel (Rear)	113"	2870 mm	114"	2896 mm	131"	3327 mm	140"	3556 mm

## LEVEL HEIGHT DIMENSIONAL DATA

	MODEL NO.	FOUR		FIVE		SIX	
J	Carriage Roller Bed (Raised)	144"	3658 mm	190"	4826 mm	236"	5994 mm
J-1	Carriage Roller Bed (Lowered)	5.5"	140 mm	5.5"	140 mm	5.5"	140 mm
K	Overall Height to Top of Frame	210"	5334 mm	256"	6502 mm	302"	7671 mm
L	Overall Height to Top of Tow Arm	223"	5664 mm	269"	6833 mm	315"	8001 mm
M	Operator Platform Height (Raised)	154"	3912 mm	200"	5080 mm	246"	6248 mm
M-1	Operator Platform Height (Lowered)	16"	406 mm	16"	406 mm	16"	406 mm
N	Shipping Height	84"	2134 mm	84"	2134 mm	84"	2134 mm
	Upper Guide* Required? (Yes / No)	Yes		Yes		Yes	
	Floor Variance (+ or - in 10ft/3m)	0.125"	3 mm	0.125"	3 mm	0.125"	3 mm

\*Guide located at the top of the unit to provide more stability for taller units

# Model/Part Number Breakdown

Example: BBE-2-36-QS-SG-XXX

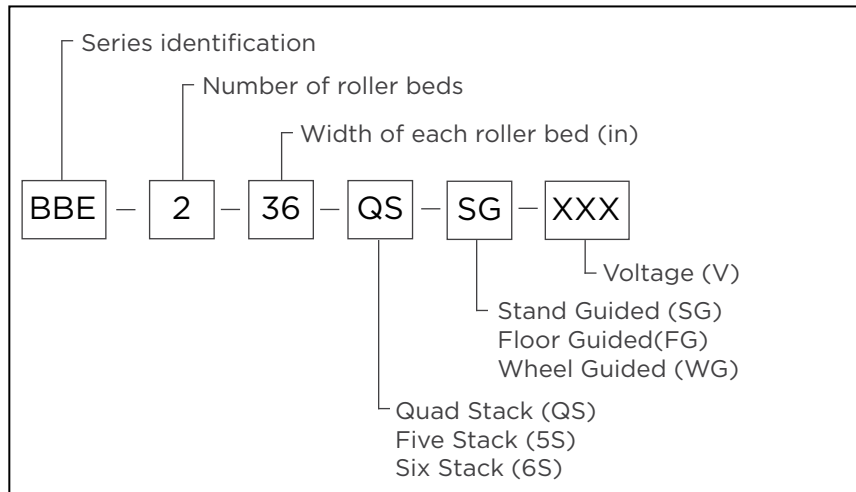

## GET IN TOUCH

info@carneybatteryhandling.com | Tel: 1.905.564.0303  
www.carneybatteryhandling.com | Toll free: 1.866.THE.BULL

*Due to continuous product improvements, specifications are subject to change without notice. Some systems and features shown may be optional at extra cost.*

CBH\_BBE6LVL\_NA\_R008