



# COBRA TUGGER

The Cobra Tugger offers a safe and reliable solution for light duty battery changing applications. Mounted on a 24 volt pallet truck, the Cobra Tugger is a simple and cost-effective way to manage low volume change requirements with a capacity of up to 2,300 lbs.

Combined with a fully electric drive system and a powerful 900 lbs electromagnet extraction, the Cobra Tugger has the same rugged uni-body construction as the BTE series and is equipped with many of the technologies employed on our larger units, including tough battery sliders, added safety features and innovative slider bed design. The low-profile design and simple user controls allow operators to quickly and effectively perform changes in a safe manner.

## GET IN TOUCH

[info@carneybatteryhandling.com](mailto:info@carneybatteryhandling.com)  
[www.carneybatteryhandling.com](http://www.carneybatteryhandling.com)

Tel: 1.905.564.0303  
Toll free: 1.866.THE.BULL

2A - 14 Reagan Road  
Brampton Ontario L7A 1B9

# Cobra Tugger

## Features and Benefits

- **Powerful 900 lbs electromagnet extraction for safe, quick and reliable changes, with up to 2,300 lbs battery capacity**

*Batteries on a slide strip bed*

- **Electric Drive Push Pull System with damage free circuit breaker system**

*Allows for maintenance free operation and reduces damage from misuse*

- **Durable Acid Resistant Powder-Coat Paint**

*Resists battery acid and other contaminants*

- **Operates on the host truck's battery pack or industrial battery via a provided parallel jumper cable, available in 24 volts.**

*No additional power source required*

- **Built to last**

*With robust unibody construction and complete electrical system for low lifetime cost of ownership*

## Available Options

### MOUNTING OPTIONS

Part #	Description
BT-Pedestal	Tugger Pedestal Mounting Spacer (Other than standard height of 2")
BT-QC-PT	Quick Clamp (Pallet Truck)
BT-QC-FT	Quick Clamp (Fork Lift Truck)

### CARRIAGE FRAME OPTIONS

Part #	Description
BT-CL	Custom Length Battery Tugger
BT-FP-3.5	3.5" deep Fork Pockets
BT-FP-2	2" Deep Fork Pocket
BT-SG	Safety Gate Bolt-On (Bar option)
BT-BGF	Fold-down Battery Guide

### ARM OPTIONS

Part #	Description
BT-AEX	Tugger Arm Extension (with tugger order) Standard reach is 5.5"

*Note: With every inch of arm length added you will lose battery length capacity in the carriage*

# Cobra Tugger

## DIMENSIONS

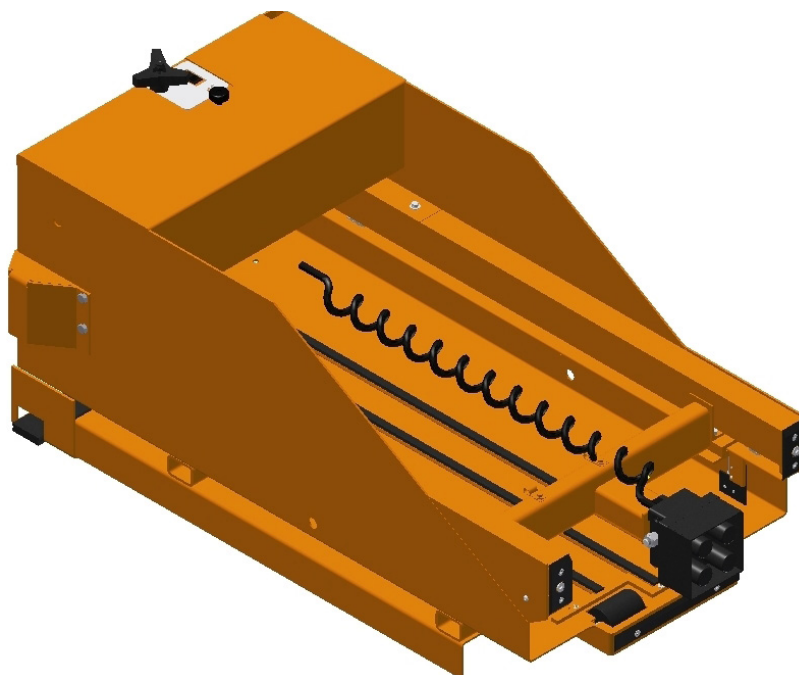
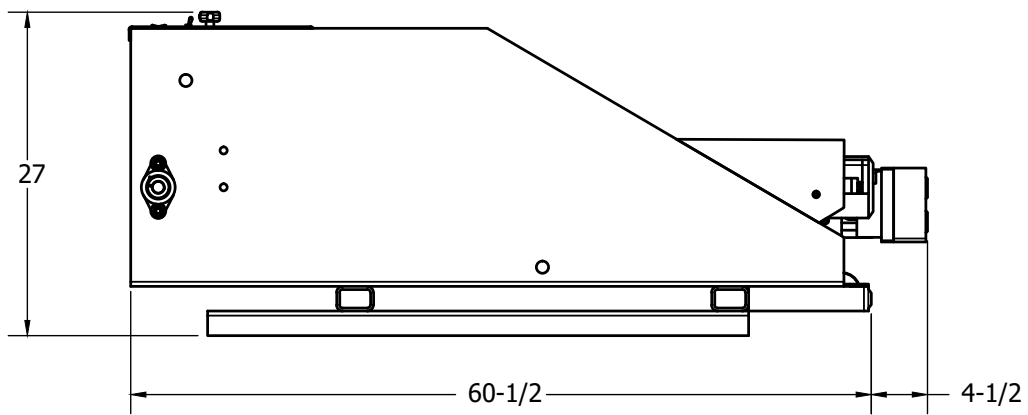
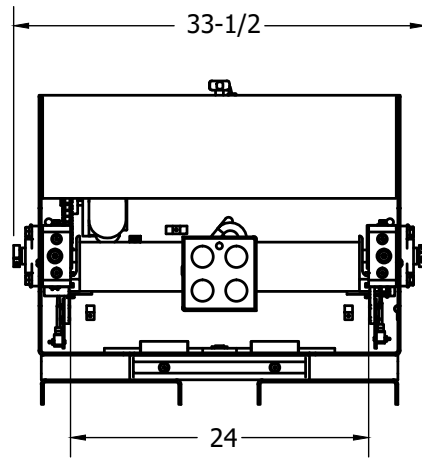

# Cobra Tugger

## SPECIFICATIONS

GENERAL SPECIFICATIONS		STANDARD	METRIC
1	Maximum battery carrying capacity	2,300 lbs	1,043 kg
2	Power pack type	Gear reduced electric	
3	Motor type	Permanent magnet DC	
4	System voltage	24 Volt DC	
5	Magnet size / pole	6" x 6" / 4	150 mm x 150mm / 4
6	Lead-in roller diameter	3" UHMW	76 mm UHMW
7	Roller shaft diameter	1/2"	12.7 mm
8	Drive chain type & size	Industrial #50	
9	Rated drawbar push/pull		
	Pull on 1/4" (6.4 mm) plate	1,280 lbs	580 kg
	Pull on 3/16" (4.75 mm) plate	900 lbs	408 kg
	Pull on 1/8" (3.2 mm) plate	525 lbs	238 kg
10	Magnet reach past bumpers	3-1/2"	89 mm
11	Service weight	588 lbs	267 kg

DIMENSIONAL DATA		STANDARD	METRIC
13	Overall length	62-1/2"	1588 mm
14	Overall width	33-1/4"	844 mm
15	Overall height (body)	27"	686 mm
16	Magnet extension past bumper	3-1/2"	89 mm
17	Battery compartment width	24"	610 mm
18	Maximum battery length	41"	1042 mm
19	Maximum battery width	23"	584 mm
20	Minimum battery width	8"	203 mm
21	Minimum battery height	9"	279 mm
22	Ground to roller height (mounted to pallet truck)	6-5/8"	158 mm

\*When fitted to a standard pallet truck with 3.35" (86mm) thick forks

# Model/Part Number Breakdown

Example: CBTE-24-24-FM

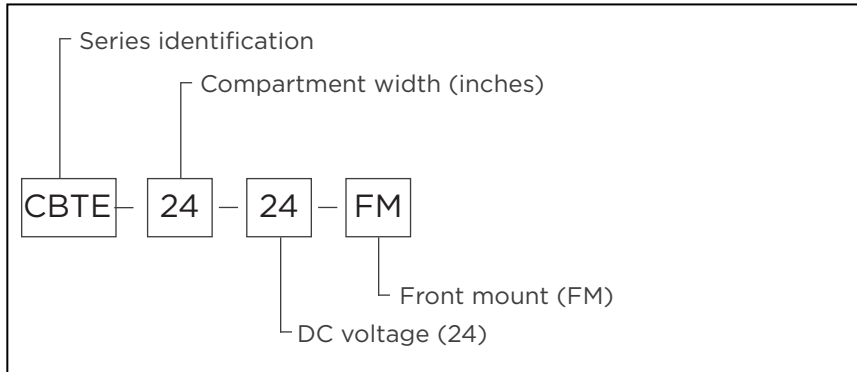

Cobra tugger on lifttruck



On/off switch for the battery extractor & forward/reverse switch

## GET IN TOUCH

info@carneybatteryhandling.com  
www.carneybatteryhandling.com

Tel: 1.905.564.0303  
Toll free: 1.866.THE.BULL

*Due to continuous product improvements, specifications are subject to change without notice. Some systems and features shown may be optional at extra cost.*

CBH\_CBTE\_NA\_R007